

Description of Parts

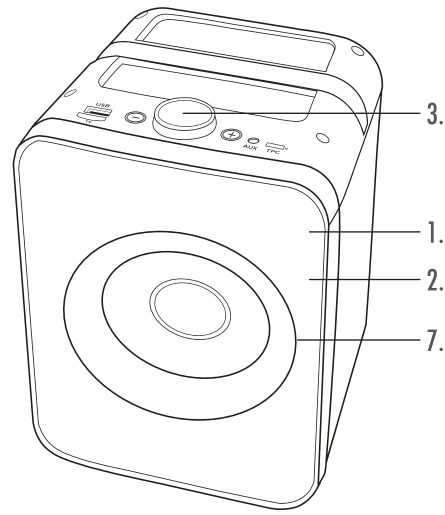

1. LED Cube Speaker main unit
2. Speaker
3. Power/function dial (**ON/OFF/FUNCTION**)
4. Skip back button (–)
5. Skip forward button (+)
6. LED indicator light
7. Colour changing LED lights
8. Type-C USB 5 V \equiv charging port
9. USB port
10. TF card slot
11. Type-C to USB charging cable
12. Carry handle

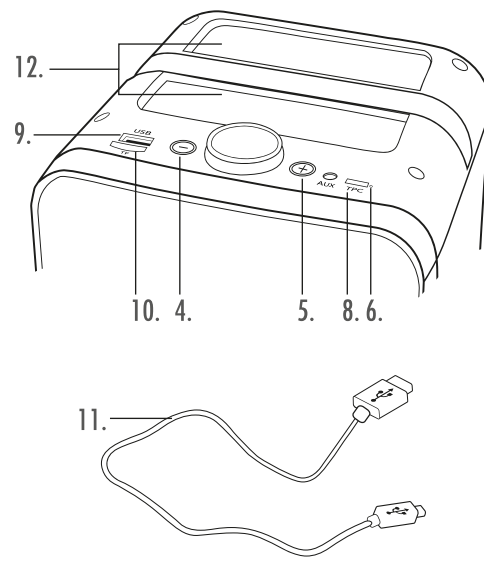

1. Unité principale de l'enceinte cube LED
2. Enceinte
3. Bouton d'alimentation/de fonction (**ON/OFF/FONCTION**)
4. Bouton retour en arrière (–)
5. Bouton saut en avant (+)
6. Voyant LED
7. Éclairage LED à changement de couleur
8. Port de charge USB Type-C 5 V \equiv
9. Port USB
10. Logement pour carte TF
11. Câble de charge Type-C vers USB
12. Poignée de transport

Type-C USB end of the USB charging cable into the Type-C 5 V \equiv charging port on the speaker and the other end to a compatible USB port.

Whilst charging, the LED indicator light will illuminate red. Once the battery has fully charged, the LED indicator light will switch off.

Carefully disconnect both ends of the USB charging cable and store it safely for future use.

Using the LED Cube Speaker Basic Functionality

Turn on the speaker by pressing and holding '**ON/OFF/FUNCTION**' for approx. 2 seconds. Pause a track by pressing '**ON/OFF/FUNCTION**'; push it again to resume the track.

To switch to the next track; press '+' once. Play the previous track by pressing '–' once.

To adjust the volume of the speaker, use the '**ON/OFF/FUNCTION**' dial. Turn clockwise to increase the volume; turn anti-clockwise to decrease the volume. Double press '**ON/OFF/FUNCTION**' to cycle through the various modes.

The colour changing LED lights will automatically activate when the speaker is turned on. Triple press '**ON/OFF/FUNCTION**' to cycle through the different colour options. The last colour option will switch off the lights.

Press and hold '**ON/OFF/VOLUME**' for approx. 2 seconds to turn the speaker off.

EN Please retain instructions for future reference.

Safety Instructions

When using electrical products, basic safety precautions should always be followed. Keep the product and its accessories out of the reach of children.

Keep small parts away from children as these may present a choking hazard.

Children under 8 years should be supervised to ensure that they do not play with the product.

This product is not a toy.

This product contains no user serviceable parts. If the product and any of its accessories are malfunctioning or damaged, the unit should be recycled.

Keep the product and its accessories away from heat sources, direct sunlight, humidity, water and any other liquid, or sharp edges that could cause damage.

Ensure the product is well-ventilated.

Do not leave any objects susceptible to magnetism (cash cards etc.) near the product.

Do not operate the product with wet hands.

Do not operate the product if it has been exposed to water, moisture or any other liquid, to prevent against electric shock, explosion and/or injury to yourself and damage to the product.

Do not use the product for anything other than its intended use.

Do not use any accessories other than those supplied.

Modes

The speaker must be turned on before using any of the following modes.

Bluetooth Mode

Pairing with a Bluetooth Compatible Device

STEP 1: Once the speaker has been turned on, a voice will sound to signal that it is ready to be paired with a Bluetooth compatible device.

STEP 2: Search for the speaker using a Bluetooth compatible device. Select 'EE7376' to connect and pair. Once a connection has been made, a voice will sound to signal that the devices are paired.

STEP 3: To unpair or remove a Bluetooth compatible device from the speaker, turn off the Bluetooth function on the compatible device. The speaker can now be paired with a new compatible device.

NOTE: Once connected, volume can be controlled using either the speaker or the relevant controls on the Bluetooth compatible device. Turn '**ON/OFF/FUNCTION**' to 100 % and the volume can then be controlled using the Bluetooth compatible device.

TF Card/USB Mode

STEP 1: To use TF card mode, insert a TF card (not included) into the TF card slot. The speaker will automatically change to TF card mode.

Do not put objects into any of the openings.

This product is intended for domestic use only. It should not be used for commercial purposes.

 To prevent possible hearing damage, do not listen at high volume levels for long periods of time – this may also damage the product.

NOTE: It is advised that the product is not used whilst charging, as this could reduce the life of the battery.

Battery Safety

The supply terminals are not to be short-circuited.

In the event of a battery and cell leaking, do not allow the liquid to come in contact with the skin or eyes. If contact has been made, wash the affected area with copious amounts of water and seek medical advice.

Secondary cells and batteries need to be charged before use. After extended periods of storage, it may be necessary to charge and discharge the cells or batteries several times to obtain maximum performance.

Keep batteries out of the reach of children.

Do not crush, puncture, dismantle or otherwise damage batteries.

Do not store above 60 °C.

Avoid storage in direct sunlight.

Do not dispose of exhausted batteries in household waste.

Do not expose the batteries to heat or fire as they may explode.

STEP 2: To use USB mode, insert a compatible USB drive into the USB input port. The speaker will automatically change to USB mode.

STEP 3: If the speaker does not automatically change to TF card/USB mode, double press '**ON/OFF/FUNCTION**' until the desired operation is selected.

NOTE: Once connected, sound can be controlled using the speaker.

No USB drive should be inserted whilst using TF card mode or vice versa, as this could interfere with playback. The speaker will only recognise MP3 audio files; if other files are present on the TF card or USB drive, this may prevent the speaker from playing.

Aux. Mode

STEP 1: Connect one end of the line-in Aux. cable to the Aux. input port on the speaker and the other end to a compatible audio source. The speaker will automatically switch to Aux. mode once the line-in Aux. cable has been inserted.

STEP 2: If the speaker does not automatically change to Aux. mode, press '**ON/OFF/FUNCTION**' twice until the desired operation is selected.

NOTE: Once connected, volume can be controlled using the relevant controls on the compatible device. The speaker cannot be used to skip tracks during Aux. mode.

Once the batteries have been exhausted, dispose of the product at a local recycling station. Contact the local government offices for further details.

This product is fitted with a 3.7 V 1200 mAh lithium ion rechargeable battery (non-removable).

Disposal of Waste Batteries and Electrical and Electronic Equipment

 This symbol on the product, its batteries or its packaging means that this product and any batteries it contains must not be disposed of with household waste.

Instead, it is the user's responsibility to hand this over to an applicable collection point for the recycling of batteries and electrical and electronic equipment. This separate collection and recycling will help to conserve natural resources and prevent potential negative consequences for human health and the environment due to the possible presence of hazardous substances in batteries and electrical and electronic equipment, which could be caused by inappropriate disposal. Some retailers provide take-back services which allow the user to return exhausted equipment for appropriate disposal. **It is the user's responsibility to delete any data on electrical and electronic equipment prior to disposal.** For more information about where to drop batteries, electrical and electronic waste off, please contact the local city/municipality office, household waste disposal service, or the retailer.

Troubleshooting

The speaker has no power.

The speaker has run out of charge. Charge the speaker following the instructions in the section entitled 'Charging the Battery'.

The speaker has no sound.

The volume level is set too low. Check that the volume level is set at an audible level and adjust accordingly with both the connected device and the speaker. The speaker is not paired with a Bluetooth compatible device. Follow the instructions in the section entitled 'Bluetooth Mode'.

Unable to pair a device with the speaker.

The Bluetooth device is not compatible with the speaker. Check that the Bluetooth device is compatible with the speaker and that the Bluetooth function is switched on.

The speaker is already connected to another device. Turn Bluetooth off on the device and try connecting again.

The charge of the speaker depletes quickly.

The volume level is set too high. Excessive use of the speaker at high volumes will drain the battery quickly. Charge the speaker following the instructions in the section entitled 'Charging the Battery' and listen at a lower volume for better results. The battery may be reaching the end of its service life and the speaker will need to be disposed of. See

LED CUBE SPEAKER ENCEINTE CUBE LED INSTRUCTION MANUAL

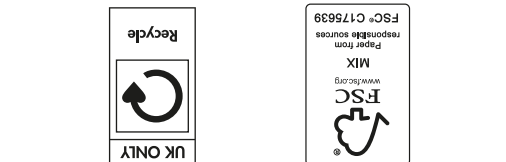
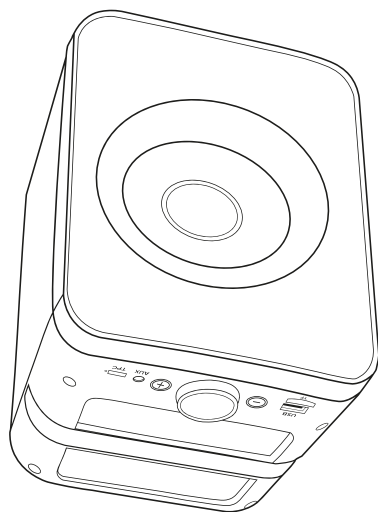

Declaration of Conformity

UP Global Sourcing UK Ltd. hereby declares that this product is in compliance with the essential requirements and other provisions of directive 2014/53/EU.

The declaration of conformity may be consulted at UP Global Sourcing UK Ltd., Victoria Street, Manchester OL9 0DD. UK. Edmund-Rumpler Straße 5, 51149 Köln. Germany. or <https://www.intempo.co.uk/declaration-letters.html>. Model No. EE7376

Care and Maintenance

Wipe the speaker with a soft, lint-free cloth.

DO NOT:

Use any abrasive cleaning solvents to clean the speaker. Expose the speaker to extremely high or low temperatures.

Drop the speaker.

Attempt to disassemble the speaker.

Dispose of the speaker in a fire, as it will result in an explosion.

Instructions for Use

Charging the Battery

The speaker is fitted with a 3.7 V 1200 mAh lithium ion rechargeable battery (non-removable). It is recommended that the battery is fully charged before first use; this will take approx. 3 hours. Connect the

