

Description of Parts

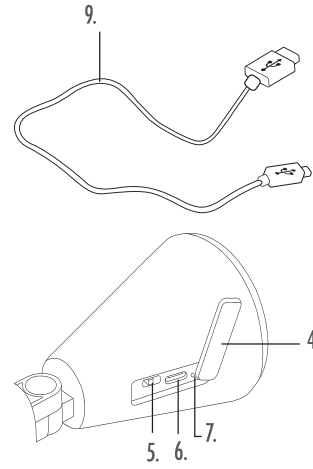
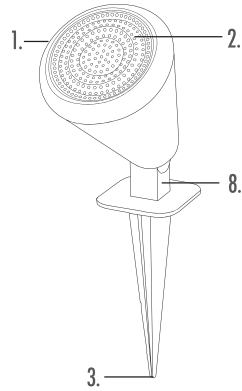
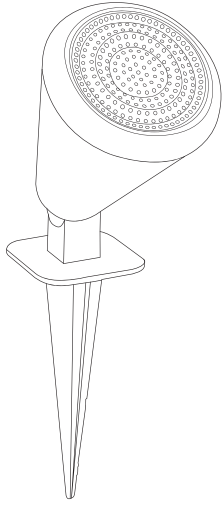

1. Bluetooth[®] Garden Speakers
2. Speaker
3. Stake
4. Cover
5. ON/OFF switch

6. Type-C 5 V \equiv charging port
7. LED indicator light
8. 180 ° hinge
9. Type-C to USB charging cable

BLUETOOTH[®] GARDEN SPEAKERS INSTRUCTION MANUAL

Do not put objects into any of the openings. This product is intended for domestic use only. It should not be used for commercial purposes.

 To prevent possible hearing damage, do not listen at high volume levels for long periods of time – this may also damage the product.

Note: It is advised that the product is not used whilst charging, as this could reduce the life of the battery.

Battery Safety

The supply terminals are not to be short-circuited.

In the event of a battery and cell leaking, do not allow the liquid to come in contact with the skin or eyes. If contact has been made, wash the affected area with copious amounts of water and seek medical advice. Secondary cells and batteries need to be charged before use. After extended periods of storage, it may be necessary to charge and discharge the cells or batteries several times to obtain maximum performance. Keep batteries out of the reach of children.

Do not crush, puncture, dismantle or otherwise damage batteries.

Do not store above 60 °C.

Avoid storage in direct sunlight.

Do not dispose of exhausted batteries in household waste.

Do not dispose of exhausted batteries in a fire as they may explode.

Once the batteries have been exhausted, dispose of the product at a local recycling station. Contact the local government offices for further details.

Each speaker is fitted with a 3.7 V 300 mAh rechargeable battery (non-removable).

Safety Instructions

When using electrical products, basic safety precautions should always be followed. Keep the product and its accessories out of the reach of children.

Keep small parts away from children as these may present a choking hazard. Children under 8 years should be supervised to ensure that they do not play with the product.

This product is not a toy.

This product contains no user serviceable parts. If the product and any of its accessories are malfunctioning or damaged; the unit should be recycled.

Keep the product and its accessories away from heat sources, direct sunlight, humidity,

water and any other liquid, or sharp edges that could cause damage.

Ensure the product is well-ventilated. Do not leave any objects susceptible to magnetism (cash cards etc.) near the product.

Do not operate the product with wet hands. Do not operate the product if it has been exposed to water, moisture or any other liquid, to prevent against electric shock, explosion and/or injury to yourself and damage to the product.

Do not use the product for anything other than its intended use.

Do not use any accessories other than those supplied.

Declaration of Conformity

UP Global Sourcing UK Ltd. hereby declares that this unit is in compliance with the essential requirements and other provisions of directive 2014/53/EU.

The declaration of conformity may be consulted at UP Global Sourcing UK Ltd., Victoria Street, Manchester OL9 0DD. UK or online at <https://intempo.co.uk/declaration-letters/> Model No. EE5919.

11/0000000/120191203

www.intempo.co.uk

Made in China.

Germany, 51149 Köln.

UK, Manchester OL9 0DD.

UP Global Sourcing UK Ltd.

Manufactured by



Care and Maintenance

Wipe the speakers with a soft, lint-free cloth.

Do not:

Use any abrasive cleaning solvents to clean the speakers.

Expose the speakers to extremely high or low temperatures.

Drop the speakers.

Attempt to disassemble the speakers

Dispose of the speakers in a fire as it will result in an explosion.

Instructions for Use

Charging the Battery

Each speaker is fitted with a 3.7 V 300 mAh battery (non-removable). It is recommended that the speaker is fully charged before first use; this will take approx. 2 hours.

Connect the Type-C connector on the charging cable into the Type-C 5 V  charging port and the other end to a compatible USB port.

Whilst charging, the LED-charging indicator light will illuminate red. Once fully charged, the LED indicator light will switch off.

Carefully disconnect both ends of the charging cable and store it safely for future use.

Note: **Maximum playtime of 7 hours based on 40 % volume.

Using the Bluetooth® Garden Speakers

Basic Functionality

Switch on both speakers by sliding the ON/OFF switch to the ON position; the speakers will automatically pair with each other.

Insert the stakes into soft ground and rotate each speaker (180 ° motion) until the desired angle is reached.

Switch the speakers off by sliding the ON/OFF switch to the OFF position.

Modes

The speaker must be turned on before using any of the following modes.

Bluetooth Mode

STEP 1: Once the speakers have been turned on, they will automatically pair with each other. The LED indicator lights will flash blue to indicate that the speakers are in pairing mode and a tone will sound signalling that the speakers are ready to be paired with a Bluetooth compatible device

STEP 2: Search for the speakers using a Bluetooth compatible device. Select 'EE5919' to connect and pair. Once a connection has been made, the LED indicator lights will stop flashing and a tone will sound to signal that the speakers are now paired

with the Bluetooth compatible device.

STEP 3: To unpair or remove a Bluetooth compatible device from the speakers, turn off the Bluetooth function on the compatible device. The speakers can now be paired with a new compatible device.

Note: Once connected, sound can be controlled using either the speakers or the relevant controls on the Bluetooth compatible device.

IPX4 Water Resistance Level

The speaker has a IPX4 water resistance level, meaning that it is safe to use where it may get splashed or in humid environments.

Warning: Do not submerge the speaker, as it is not intended to function underwater.

Specifications

Product code: EE5919BMFOB

Bluetooth version: 5.0

Wireless distance: Up to 25 m*

Impedance: 4 Ω

Sensitivity: 80 dB

Frequency response: 30 Hz–20 kHz

Charging voltage: 5 V 

Battery: 2 x 300 mAh

IPX4

Bluetooth Frequency: 2.4 GHz

Max RF Output: < 6 dBm

* Effective range may be reduced due to the presence of obstacles between connected devices.